

ENGINEER'S REPORT

2026 SANITARY LATERAL RECONSTRUCTION

SCHINDLER DRIVE | SUNSET DRIVE TO FULCER AVENUE
FULCER AVENUE | ROGER STREET TO SCHINDLER DRIVE
PINE STREET / WALNUT STREET ALLEY | KIMBERLY AVENUE TO 2ND STREET

2026 STORM LATERAL CONSTRUCTION

SCHINDLER DRIVE | SUNSET DRIVE TO FULCER AVENUE
PINE STREET / WALNUT STREET ALLEY | KIMBERLY AVENUE TO 2ND STREET

2026 DRIVEWAY APRON RECONSTRUCTION

SCHINDLER DRIVE | SUNSET DRIVE TO FULCER AVENUE
FULCER AVENUE | ROGER STREET TO SCHINDLER DRIVE
PINE STREET / WALNUT STREET ALLEY | KIMBERLY AVENUE TO 2ND STREET

FOR THE
VILLAGE OF KIMBERLY
OUTAGAMIE COUNTY, WISCONSIN



MARCH 4, 2026



McMAHON ASSOCIATES, INC.
1445 McMAHON DRIVE NEENAH, WI 54956 Mailing: PO BOX 1025 NEENAH, WI 54957-1025 PH 920.751.4200 MCMGRP.COM
McM. No. K0001-09-25-00632 /BDW:car



ENGINEER'S REPORT TABLE OF CONTENTS

PROJECT LOCATION MAP

ENGINEER'S REPORT

2026 SANITARY LATERAL RECONSTRUCTION

Purpose of the Sanitary Lateral Project

Establishment of the Sanitary Lateral Assessment Rate

2026 STORM LATERAL RECONSTRUCTION

Purpose of the Storm Lateral Project

Establishment of the Schindler Drive Storm Lateral Assessment Rate

2026 DRIVEWAY APRON RECONSTRUCTION

Apron Assessment

FINANCING OF ASSESSMENTS

PLANS & SPECIFICATIONS

PUBLIC HEARING

BID TABULATION

SCHEDULE OF ASSESSMENTS

WAIVER OF SPECIAL ASSESSMENT &

RIGHT TO ACCESS PRIVATE PROPERTY FORM



w:\PROJECTS\K00011092500632\CADD\GIS\Engineer's Reports.aprx\3rdStreet_A February 16, 2026 kpk

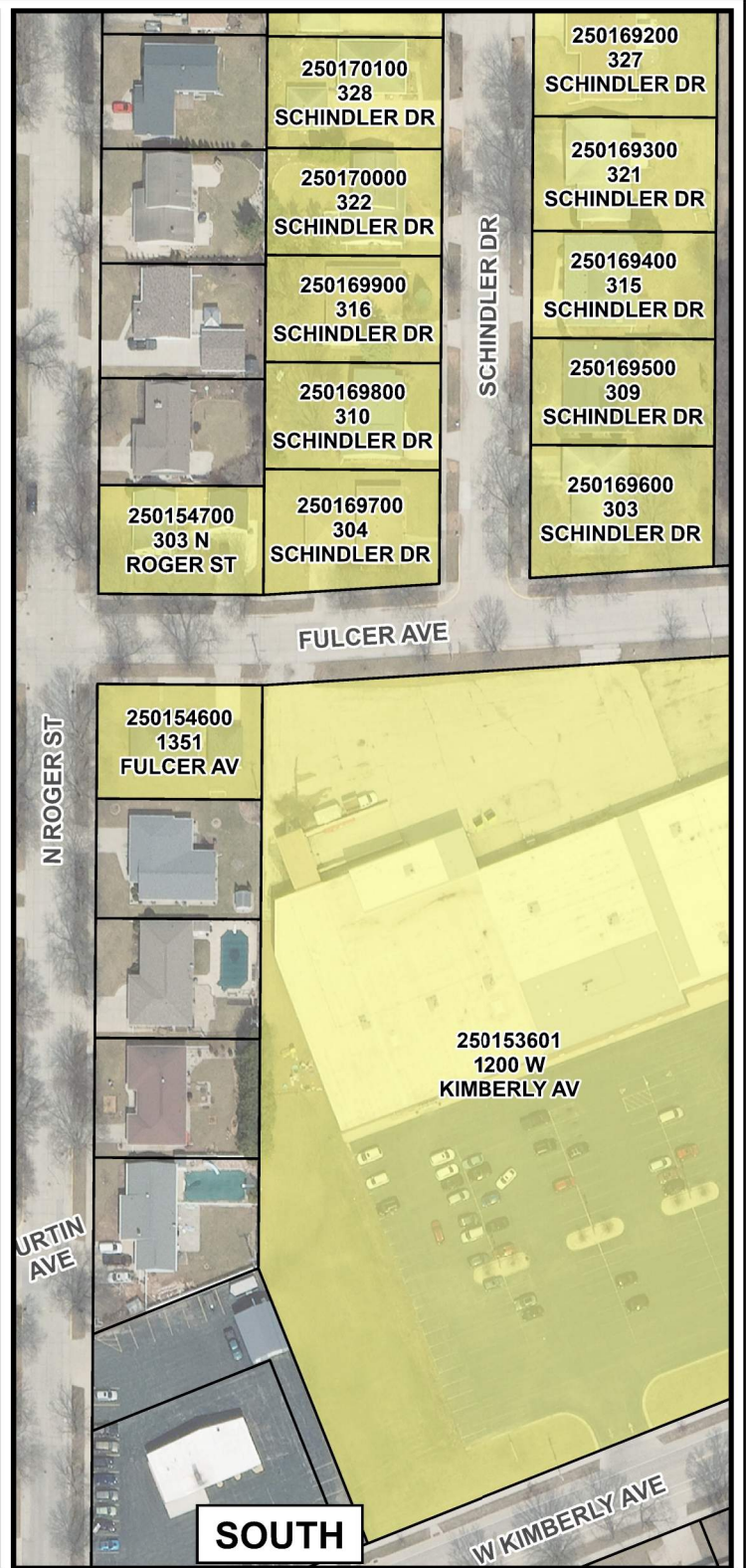
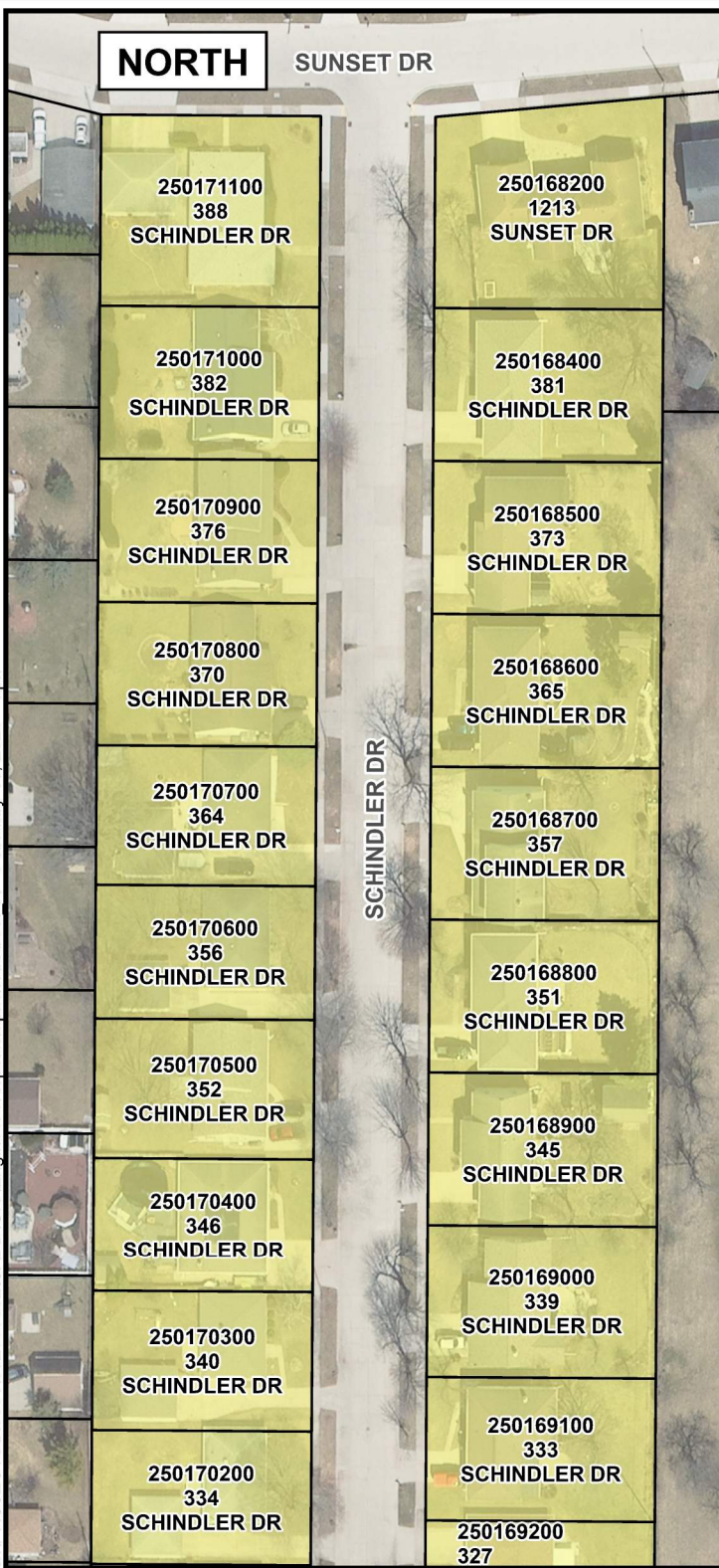

Mapped Features

- Reconstruction Parcel
- Parcel Line



Source: Outagamie County, 2025-26.

Disclaimer: The property lines, right-of-way lines, and other property information on this drawing were developed or obtained as part of the County Geographic Information System or through the County property tax mapping function. McMAHON ASSOCIATES, INC. does not guarantee this information to be correct, current, or complete. The property and right-of-way information are only intended for use as a general reference and are not intended or suitable for site-specific uses. Any use to the contrary of the above stated uses is the responsibility of the user and such use is at the user's own risk.



McMAHON
ENGINEERS ARCHITECTS
McMAHON ASSOCIATES, INC.

FIGURE 1
SCHINDLER DRIVE AND
FULCER AVENUE
2026 SANITARY LATERAL,
STORM LATERAL AND CONCRETE
APRON RECONSTRUCTION
VILLAGE OF KIMBERLY
OUTAGAMIE COUNTY, WISCONSIN

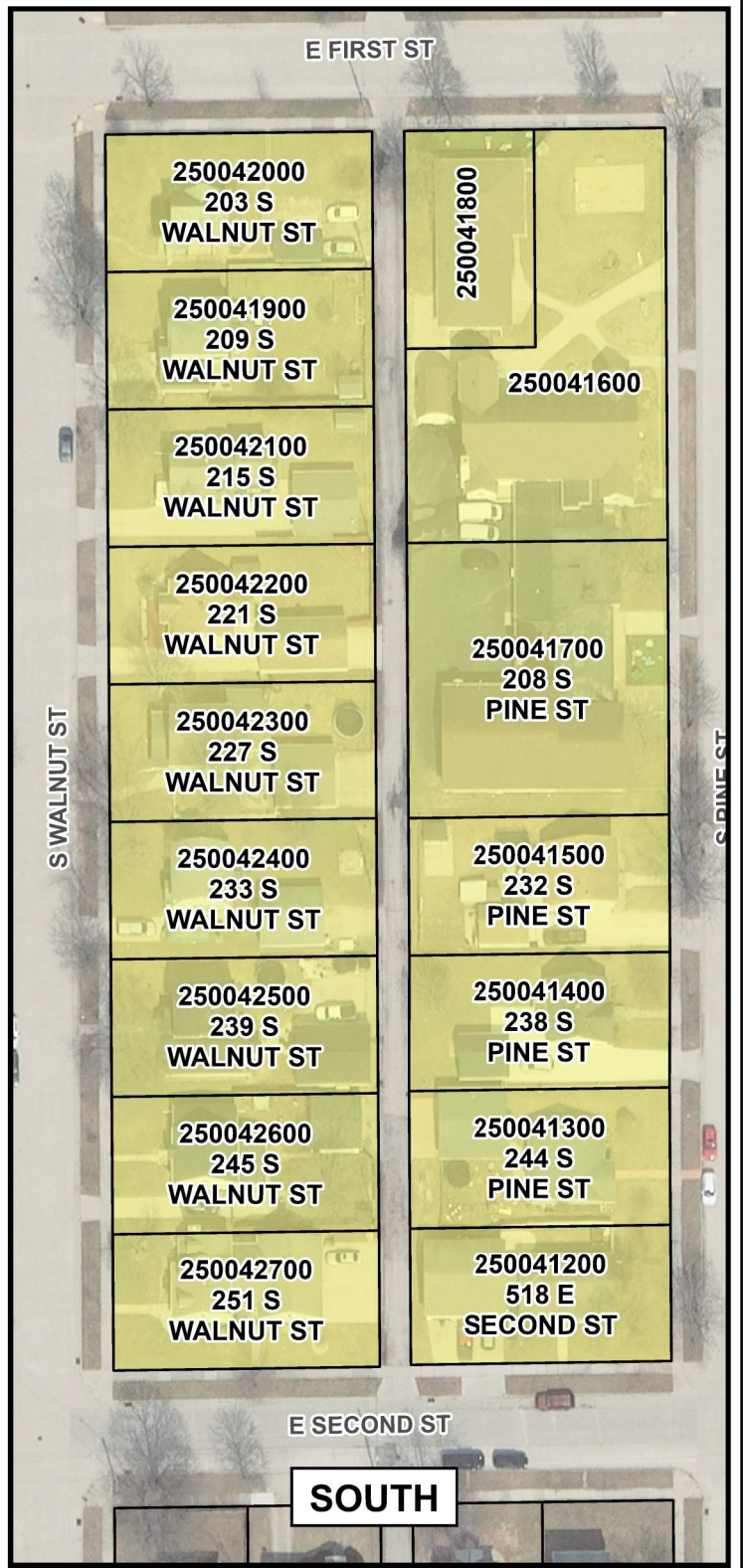

Mapped Features

- Reconstruction Parcel
- Parcel Line



NOT TO SCALE

Source: Outagamie County, 2025-26.

Disclaimer: The property lines, right-of-way lines, and other property information on this drawing were developed or obtained as part of the County Geographic Information System or through the County property tax mapping function. McMAHON ASSOCIATES, INC. does not guarantee this information to be correct, current, or complete. The property and right-of-way information are only intended for use as a general reference and are not intended or suitable for site-specific uses. Any use to the contrary of the above stated uses is the responsibility of the user and such use is at the user's own risk.



McMAHON
ENGINEERS ARCHITECTS
McMAHON ASSOCIATES, INC.

FIGURE 2
WALNUT STREET/PINE STREET ALLEY
2026 SANITARY SEWER AND DRIVEWAY RECONSTRUCTION
VILLAGE OF KIMBERLY
OUTAGAMIE COUNTY, WISCONSIN



Mapped Features

- Reconstruction Parcel
- Parcel Line



Source: Outagamie County, 2025-26.

Disclaimer: The property lines, right-of-way lines, and other property information on this drawing were developed or obtained as part of the County Geographic Information System or through the County property tax mapping function. McMAHON ASSOCIATES, INC. does not guarantee this information to be correct, current, or complete. The property and right-of-way information are only intended for use as a general reference and are not intended or suitable for site-specific uses. Any use to the contrary of the above stated uses is the responsibility of the user and such use is at the user's own risk.



McMAHON
ENGINEERS ARCHITECTS
McMAHON ASSOCIATES, INC.

FIGURE 3
E. THIRD STREET
2026 SANITARY LATERAL
RECONSTRUCTION
VILLAGE OF KIMBERLY
OUTAGAMIE COUNTY, WISCONSIN

ENGINEER'S REPORT



2026 SANITARY LATERAL RECONSTRUCTION

SCHINDLER DRIVE | SUNSET DRIVE TO FULCER AVENUE
FULCER AVENUE | ROGER STREET TO SCHINDLER DRIVE
PINE STREET / WALNUT STREET ALLEY | KIMBERLY AVENUE TO 2ND STREET

2026 STORM SEWER LATERAL RECONSTRUCTION

SCHINDLER DRIVE | SUNSET DRIVE TO FULCER AVENUE
PINE STREET / WALNUT STREET ALLEY | KIMBERLY AVENUE TO 2ND STREET

2026 DRIVEWAY APRON RECONSTRUCTION

SCHINDLER DRIVE | SUNSET DRIVE TO FULCER AVENUE
FULCER AVENUE | ROGER STREET TO SCHINDLER DRIVE
PINE STREET / WALNUT STREET ALLEY | KIMBERLY AVENUE TO 2ND STREET

VILLAGE OF KIMBERLY

OUTAGAMIE COUNTY, WISCONSIN

MARCH 4, 2026

McM. No. K0001-09-25-00632



1. This Engineer's Report, submitted on behalf of the above-named municipality, is prepared in compliance with Section 66.0703(1)(b), Wisconsin Statutes, and Section 66.0703(3), Wisconsin Statutes, as amended.
2. That all Preliminary and Final Plans and Specifications for the aforementioned municipal project are on file with the Clerk of the municipality.
3. That following hereinafter is an estimate of the entire cost of the proposed work or improvements, either based upon the Engineer's estimates or based upon actual bids received for said proposed work or improvements by the named municipality.
4. That hereinafter follows an estimate, as to each parcel of property affected, of the assessment of benefits to be levied against each affected parcel.
5. The same is attached hereto and incorporated herein as a schedule of proposed assessments.
6. That it has been determined by the governing body of the aforementioned municipality and the Engineers for the municipality, that the property against which the assessments are made are benefited from said proposed work, improvements and installation of the same, and that all assessments are pursuant to Sections 66.0703(1)(b) Police Powers, and that said assessments are based upon a reasonable basis, as determined by said government body, mainly being construction costs assessment, including actual cost of construction, engineering fees, legal fees, posting and publication expenses.

McMahon Associates, Inc.

By: 
 Brad D. Werner, P.E.
 Vice President / Senior Municipal Engineer



2026 SANITARY LATERAL RECONSTRUCTION

SCHINDLER DRIVE | SUNSET DRIVE TO FULCER AVENUE

FULCER AVENUE | ROGER STREET TO SCHINDLER DRIVE

PINE STREET / WALNUT STREET ALLEY | KIMBERLY AVENUE TO 2ND STREET

PURPOSE OF THE SANITARY LATERAL PROJECT

The purpose of the project is to provide the abutting property owners with a dependable sanitary sewerage collection system and lateral to the home, in conformance with the Village of Kimberly Sanitary Sewer System Replacement Program adopted March 3, 2003 and amended March 23, 2005, and the Infrastructure Standards & Special Assessment Policy adopted January 19, 2021 and updated March 2, 2026.

ESTABLISHMENT OF THE SANITARY LATERAL ASSESSMENT RATE

SANITARY LATERAL REPLACEMENT IN VILLAGE RIGHT-OF WAY OR EASEMENT

The Village shall construct the lateral in the Village right-of-way or easement at which point the homeowner is responsible to have the lateral reconstructed and reconnected to the home. The assessed cost for the lateral from the mainline sanitary sewer to the extent of the Village owned or leased property shall be calculated assuming the mainline sanitary sewer is centered in the right-of-way or easement. This shall create an equity of costs to adjacent property owned and not lend an advantage to any homeowner based upon the actual location of the sanitary mainline. The assessment may be financed through the Village of Kimberly.

SANITARY LATERAL REPLACEMENT ON PRIVATE PROPERTY TO THE HOME CONNECTION

The Village of Kimberly sanitary sewer policy requires the property owner replace their lateral from the Village mainline sanitary sewer to the connection at the home if the lateral is found to be in violation of the Village Ordinances. The Village has requested unit prices for the replacement of laterals on private property from the project contractor. A summary of these costs are shown in this Engineer's Report.

The lateral shall be reconstructed to the home connection as a part of the Village contract based on the estimated unit costs provided. The contractor may adjust these costs up or down based on unique circumstances on any given lot. Variations from the unit costs provided shall be identified prior to authorization to proceed by the homeowner.

- Pricing is typically most cost-effective by pipe bursting or CIPP lining of the existing lateral to achieve compliance with the Village Sanitary Sewer Policy. These methods most often result in no disturbance to private property.
- No restoration by the contractor is included in the costs provided. Surface restoration shall be the responsibility of the homeowner.
- Removal and replacement of landscaping, structures, etc. which may affect the ability of the contractor to complete the work shall be the responsibility of the property owner.
- The Village contractor's costs to install the lateral may be placed on the assessment roll and financed through the Village of Kimberly.

- The property owner shall sign and return a waiver of Special Assessment Form to the Village of Kimberly Municipal Services Center, 426 W. Kimberly Avenue, by April 17, 2026 (form is attached). An estimate of the cost of the private lateral work can be provided upon request. This estimate may be more or less than the actual cost and should not be considered to be a not to exceed cost.

**ESTIMATED SANITARY LATERAL ASSESSMENT RATE FOR SANITARY LATERAL WORK
IN VILLAGE RIGHT-OF-WAY OR EASEMENT**

The costs included are all construction, administrative, legal, engineering and contingency costs required to provide a new lateral to the right-of-way or easement line in conformance with the Village of Kimberly standard. The estimated cost shown is the average cost for the project area identified in this report. The final assessment will be equal to this amount or lower.

SCHINDLER DRIVE / FULCER AVENUE | PINE STREET / WALNUT STREET ALLEY | THIRD STREET

| Bid Item | Qty/Unit | Description | Unit Price | Total |
|-----------------|-----------------|---|-------------------|--------------|
| 3. | 35 L.F. | 4 Inch Sanitary Lateral – Excavated | \$66.82 | \$2,338.70 |
| 62. | 80 L.F. | 4 Inch Sanitary Lateral – Excavated | \$101.00 | \$8,080.00 |
| 4. | 1,080 L.F. | 4 Inch HDPE DR 17 Sanitary Lateral – Pipe Burst in Right-of-Way | \$5.05 | \$5,454.00 |
| 5. | 60 Ea. | 4" x 8" Wye Connection Including Riser | \$298.00 | \$17,880.00 |
| 9. | 60 Ea. | Post-Construction Lateral Televising | \$98.98 | \$5,938.80 |
| | | Construction Total | | \$39,691.50 |
| | | 25% Engineering & Contingencies | | \$9,922.88 |
| | | Estimated Total Project Cost | | \$49,614.38 |

Estimated Lateral in the Right-of-Way Assessment = \$49,614.38 ÷ 60 Each = \$826.91/Ea.

ESTIMATED PRIVATE SANITARY LATERAL COST

An estimated cost has been provided based on an assumed lateral length. Any individual lateral assessment may be more or less than this estimate based on the actual method of construction, length and unique circumstances of each private lateral reconstruction.

ESTIMATED COST OF A PRIVATE SANITARY LATERAL

Lateral Portion on Private Property Pipe Burst to the Home Interior Reconnection

SCHINDLER DRIVE & FULCER AVENUE: The estimated costs for a typical 4-inch lateral assuming 40' of lateral are as follows:

| Item | Qty/Unit | Description | Unit Price | Total |
|----------------|----------|------------------------------------|------------|------------|
| 11. | 1 Ea. | Pipe Burst Set-Up Fee | \$3,030.00 | \$3,030.00 |
| 12. | 40 L.F. | 4 Inch HDPE DR 17 Sanitary Lateral | \$5.05 | \$202.00 |
| 15. | 1 Ea. | 4 Inch Furnco Connection | \$25.25 | \$25.25 |
| 16. | 1 Ea. | 4 Inch Bend | \$20.20 | \$20.20 |
| 17. | 1 Ea. | Inside Cleanout | \$50.50 | \$50.50 |
| 18. | 1 Ea. | Cleanout Cap | \$10.10 | \$10.10 |
| 19. | 1 Ea. | Floor Drain | \$101.00 | \$101.00 |
| 20. | 5 Bags | Redi-Crete Floor Restoration | \$20.20 | \$101.00 |
| Estimated Cost | | | | \$3,540.05 |

PINE STREET / WALNUT STREET ALLEY | KIMBERLY AVENUE TO 2ND STREET & 3RD STREET | WALNUT STREET TO PINE STREET: The estimated costs for a typical 4-inch lateral assuming 75' of lateral are as follows:

| Item | Qty/Unit | Description | Unit Price | Total |
|----------------|----------|------------------------------------|------------|------------|
| 71. | 75 L.F. | 4 Inch HDPE DR 17 Sanitary Lateral | \$5.10 | \$382.50 |
| 74. | 1 Ea. | Pipe Burst Set-Up Fee | \$3,030.00 | \$3,030.00 |
| 75. | 1 Ea. | 4 Inch Furnco Connection | \$25.25 | \$25.25 |
| 76. | 1 Ea. | 4 Inch Bend | \$20.20 | \$20.20 |
| 77. | 1 Ea. | Inside Cleanout | \$50.50 | \$50.50 |
| 78. | 1 Ea. | Cleanout Cap | \$10.10 | \$10.10 |
| 79. | 1 Ea. | Floor Drain | \$101.00 | \$101.00 |
| 80. | 5 Bags | Redi-Crete Floor Restoration | \$20.20 | \$101.00 |
| Estimated Cost | | | | \$3,720.55 |

*If a private lateral is requested to be excavated to the home no restoration of “non-turf” landscaping, pavement, structures, etc. is included. The contractor shall only be responsible to backfill the trench and restore it as grass turf.

**The actual cost per home shall be calculated using the unit bid prices and the actual footage of pipe fittings used and any other unique costs associated with reconstruction of a specific private lateral.

The estimated cost of a private sanitary lateral should **not be** considered a not to exceed cost as the final cost can be more based on the unique nature of each private lateral.

2026 STORM LATERAL CONSTRUCTION

SCHINDLER DRIVE | SUNSET DRIVE TO FULCER AVENUE

PINE STREET / WALNUT STREET ALLEY | KIMBERLY AVENUE TO 2ND STREET

PURPOSE OF THE STORM LATERAL PROJECT

The purpose of the project is to provide the abutting property owners with a dependable mini-storm sewer and/or lateral to collect sump pump discharge, in conformance with the Village of Kimberly Mini-Storm Sewer Policy adopted March 15, 1993, and Infrastructure Standards & Special Assessment Policy adopted January 19, 2021 and updated March 2, 2026.

ESTABLISHMENT OF THE SCHINDLER DRIVE STORM LATERAL ASSESSMENT RATE

SUMMARY OF COSTS

The costs are estimated and include construction costs, engineering, legal and contingencies or the construction of the storm lateral to the right-of-way.

| Item | Qty/Unit | Description | Unit Price | Total |
|------|----------|--|------------|-------------|
| 45. | 9 Ea. | 4 Inch Storm Lateral Inserta Tee Connection to 18 Inch PVC Main | \$280.00 | \$2,520.00 |
| 46. | 380 L.F. | 4 Inch Storm Sewer Lateral (Public) | \$59.00 | \$22,420.00 |
| 8. | 225 S.F. | Remove and Replace 4 Inch Sidewalk | \$8.45 | \$1,901.25 |
| | | Construction Total | | \$26,841.25 |
| | | 25% Engineering & Contingencies | | \$6,710.31 |
| | | Estimated Total Project Cost | | \$33,551.56 |

SCHINDLER DRIVE STORM LATERAL RATE

This rate is established by dividing the total cost by the number of new properties served. At this time, the project is an estimate, therefore, the rate shown is also an estimate. The final assessment rate should be equal to this estimate or lower. The Village of Kimberly Mini-Storm Policy states that 70% of the project cost shall be assessed to the serviced properties.

Estimated Total Assessment Rate = \$33,551.56 ÷ 9 Ea. = \$3,727.95/Ea.

Estimated Net & Assessment Rate (70% x \$3,727.95) = \$2,609.57/Ea.

PRIVATE STORM LATERAL WORK

The following are unit prices for private storm lateral work required to extend the lateral from the right-of-way to the home connection. The homeowner is required to have the Village contractor due this work. An estimate can be provided. Only turf restoration is included in the cost of lateral. Specialized landscaping or pavement is not included, and the homeowner is responsible for restoring these items. The cost of the installation of a private storm lateral completed under the Village contract is eligible to be placed on the Village annual payment plan.

The property owner shall sign and return a Waiver of Special Assessment Form to the Village of Kimberly Municipal Services Building, 426 W. Kimberly Avenue, by April 17, 2026 (form is attached).

GENERAL ESTIMATE: Assumes the connection at the home is 50' or less from the right-of-way.

| Item | Qty/Unit | Description | Unit Price | Total |
|-------------|-----------------|--|-------------------|--------------|
| 47. | 50 L.F. | 4 Inch Storm Sewer Lateral (Private) with Turf Restoration | \$40.00 | \$2,000.00 |
| 48. | 1 Ea. | Collection Riser at House (Private) | \$200.00 | \$200.00 |
| | | Estimated Cost | | \$2,200.00 |

*The estimated cost of a private storm lateral should **not be** considered a not to exceed cost as the final cost can be more based on the unique nature of each private lateral.

2026 DRIVEWAY APRON RECONSTRUCTION

SCHINDLER DRIVE | SUNSET DRIVE TO FULCER AVENUE

FULCER AVENUE | ROGER STREET TO SCHINDLER DRIVE

PINE STREET / WALNUT STREET ALLEY | KIMBERLY AVENUE TO 2ND STREET

The purpose of the project is to provide the abutting property owners with a dependable street system, consisting of concrete pavement. As a result of the street reconstruction the concrete driveway apron shall be replaced to match the new street grade. The property owner shall be assessed for the reconstruction of the full apron. The Schedule of Assessments includes an estimate of this charge based on the size of the apron as shown on the project plans. Should the size of the driveway opening width be increased or decreased the assessment shall also increase or decrease accordingly.

APRON ASSESSMENT

The Apron Assessment shown is only an approximation of an apron. The property owner shall be assessed for the actual size of the apron installed. The assessed cost may be more or less than the following example based on the actual size constructed. The following example estimates were prepared using the bid cost/square foot for concrete aprons or asphalt aprons.

SCHINDLER DRIVE & FULCER AVENUE

e.g. Concrete Apron
(24') (8.5) (\$9.60/S.F.) = \$1,958.40

PINE STREET / WALNUT STREET ALLEY

e.g. Asphalt Apron
(24') (8) (\$2.91/S.F.) = \$558.72

e.g. Concrete Apron
(20') (8) (\$12.40/S.F.) = \$1,984.00

FINANCING OF ASSESSMENTS

The Village of Kimberly has budgeted funds for the financing of the project and will assess the cost back as shown on the attached Schedule of Assessments. The assessments are billed to the property owners on a selected payment plan. The total assessment balance can also be paid in full. **The interest rate to the property owners will be at prime rate plus 1%. The final interest rate will be provided at the public hearing.**

PLANS & SPECIFICATIONS

As part of this Engineer's Report, plans and specifications, as prepared by McMahon Associates, Inc., Project No. K0001-09-25-00632 and Project No. K0001-09-25-00633 can be found at the Municipal Clerk's Office, 515 W. Kimberly Avenue, on-line and at the Public Hearing.

PUBLIC HEARING

The Village of Kimberly will hear all persons interested, or their agents or attorneys, concerning matters contained in the Preliminary Resolution Authorization, such assessments, and the Reports of the Engineers at 5:00 p.m. on the 16th day of March 2026, in the Village of Kimberly Municipal Building located at 515 W. Kimberly Avenue, Kimberly, Wisconsin.

BID TABULATION

OWNER: VILLAGE OF KIMBERLY
Project Name: 2026 Utility Reconstruction
 Schindler Drive, Fulcer Avenue and Pine/Walnut Alley
 K0001-09-25-00632
Contract No. K0001-09-25-00632
Bid Date/Time: February 20, 2026 @ 10:00 a.m.
Project Manager: Brad Werner, PE

Engineer: McMAHON ASSOCIATES, INC.
 1445 McMahan Drive
 PO Box 1025
 Neenah, WI 54956 / 54957-1025

DONALD HIETPAS & SONS, INC.
 1450 E. North Avenue
 PO Box 166
 Little Chute, WI 54140

DAVID TENOR CORPORATION
 1651 Brookfield Avenue, Suite 12
 Green Bay, WI 54313

KRUCZEK CONSTRUCTION, INC.
 3636 Kewaunee Road
 Green Bay, WI 54311

DORNER, INC.
 E506 Luxemburg Road
 PO Box 129
 Luxemburg, WI 54217

SANITARY SEWER | Schindler Drive and Fulcer Avenue

| Item | Qty | Unit | Description | Unit Price | Total | Unit Price | Total | Unit Price | Total | Unit Price | Total |
|------|-------|------|--|------------|--------------|-------------|--------------|-------------|-------------|-------------|--------------|
| 1. | 1 | L.S. | Mobilization / Bonding | \$2,279.34 | \$2,279.34 | \$4,430.00 | \$4,430.00 | \$4,523.00 | \$4,523.00 | \$5,408.00 | \$5,408.00 |
| 2. | 1,258 | L.F. | 8 Inch SDR 35 PVC Sanitary Sewer | \$80.00 | \$100,640.00 | \$85.00 | \$106,930.00 | \$78.00 | \$98,124.00 | \$117.00 | \$147,186.00 |
| 3. | 35 | L.F. | 4 Inch Sanitary Lateral - Excavated | \$66.82 | \$2,338.70 | \$91.00 | \$3,185.00 | \$100.00 | \$3,500.00 | \$96.00 | \$3,360.00 |
| 4. | 870 | L.F. | 4 Inch HDPE DR 17 Sanitary Lateral - Pipe Burst in Right-of-Way | \$5.05 | \$4,393.50 | \$5.15 | \$4,480.50 | \$5.00 | \$4,350.00 | \$5.28 | \$4,593.60 |
| 5. | 30 | Ea. | 4" x 8" Wye Connection Including Riser | \$298.00 | \$8,940.00 | \$300.00 | \$9,000.00 | \$475.00 | \$14,250.00 | \$225.00 | \$6,750.00 |
| 6. | 37 | V.F. | 48 Inch Sanitary Manhole | \$490.00 | \$18,130.00 | \$632.00 | \$23,384.00 | \$590.00 | \$21,830.00 | \$711.00 | \$26,307.00 |
| 7. | 4 | Ea. | Manhole Casting | \$625.00 | \$2,500.00 | \$545.00 | \$2,180.00 | \$675.00 | \$2,700.00 | \$487.00 | \$1,948.00 |
| 8. | 1 | L.S. | Post-Construction Mainline Cleaning and Televising (Approx. 1,298 ft.) | \$1,947.08 | \$1,947.08 | \$1,986.00 | \$1,986.00 | \$2,400.00 | \$2,400.00 | \$2,323.00 | \$2,323.00 |
| 9. | 30 | Ea. | Post-Construction Lateral Televising | \$98.98 | \$2,969.40 | \$101.00 | \$3,030.00 | \$110.00 | \$3,300.00 | \$116.00 | \$3,480.00 |
| 10. | 1 | L.S. | Sanitary Sewer Trench Compaction and Certification | \$2,750.00 | \$2,750.00 | \$10,150.00 | \$10,150.00 | \$10,000.00 | \$10,000.00 | \$10,452.00 | \$10,452.00 |

SANITARY LATERAL WORK ON PRIVATE PROPERTY | Schindler Drive and Fulcer Avenue

| Item | Qty | Unit | Description | Unit Price | Total | Unit Price | Total | Unit Price | Total | Unit Price | Total |
|--|-------|------|---|---------------------|-------------|---------------------|-------------|---------------------|-------------|---------------------|-------------|
| 11. | 29 | Ea. | Pipe Burst Set-Up Fee | \$3,030.00 | \$87,870.00 | \$3,090.00 | \$89,610.00 | \$3,050.00 | \$88,450.00 | \$3,167.00 | \$91,843.00 |
| 12. | 1,000 | L.F. | 4 Inch HDPE DR 17 Sanitary Lateral - Pipe Burst Private | \$5.05 | \$5,050.00 | \$5.15 | \$5,150.00 | \$5.00 | \$5,000.00 | \$5.28 | \$5,280.00 |
| 13. | 1 | Ea. | Outside Spot Excavation | \$505.00 | \$505.00 | \$515.00 | \$515.00 | \$500.00 | \$500.00 | \$528.00 | \$528.00 |
| 14. | 1 | Ea. | Outside Cleanout with Frost Sleeve | \$252.50 | \$252.50 | \$257.00 | \$257.00 | \$250.00 | \$250.00 | \$264.00 | \$264.00 |
| 15. | 44 | Ea. | 4 Inch Furnco Connection | \$25.25 | \$1,111.00 | \$26.00 | \$1,144.00 | \$25.00 | \$1,100.00 | \$26.00 | \$1,144.00 |
| 16. | 60 | Ea. | 4 Inch Bend | \$20.20 | \$1,212.00 | \$21.00 | \$1,260.00 | \$20.00 | \$1,200.00 | \$21.00 | \$1,260.00 |
| 17. | 29 | Ea. | Inside Cleanout | \$50.50 | \$1,464.50 | \$51.00 | \$1,479.00 | \$50.00 | \$1,450.00 | \$53.00 | \$1,537.00 |
| 18. | 29 | Ea. | Cleanout Cap | \$10.10 | \$292.90 | \$11.00 | \$319.00 | \$10.00 | \$290.00 | \$11.00 | \$319.00 |
| 19. | 29 | Ea. | Floor Drain | \$101.00 | \$2,929.00 | \$103.00 | \$2,987.00 | \$100.00 | \$2,900.00 | \$106.00 | \$3,074.00 |
| 20. | 120 | BAG | Redi-Crete Floor Restoration | \$20.20 | \$2,424.00 | \$21.00 | \$2,520.00 | \$20.00 | \$2,400.00 | \$21.00 | \$2,520.00 |
| 21. | 1 | Ea. | CIPP Liner Set Up Cost | \$1,262.50 | \$1,262.50 | \$1,288.00 | \$1,288.00 | \$1,275.00 | \$1,275.00 | \$1,320.00 | \$1,320.00 |
| 22. | 40 | L.F. | 4 Inch CIPP Liner | \$75.75 | \$3,030.00 | \$77.25 | \$3,090.00 | \$76.50 | \$3,060.00 | \$79.18 | \$3,167.20 |
| SUB-TOTAL (Items 1. through 22., Inclusive) | | | | \$254,291.42 | | \$278,374.50 | | \$272,852.00 | | \$324,063.80 | |

WATER MAIN | Schindler Drive and Fulcer Avenue

| Item | Qty | Unit | Description | Unit Price | Total | Unit Price | Total | Unit Price | Total | Unit Price | Total |
|---|-------|------|--|---------------------|--------------|---------------------|--------------|---------------------|--------------|---------------------|--------------|
| 23. | 1 | L.S. | Mobilization / Bonding | \$2,279.34 | \$2,279.34 | \$8,000.00 | \$8,000.00 | \$1,200.00 | \$1,200.00 | \$5,408.00 | \$5,408.00 |
| 24. | 1 | L.S. | Temporary Water Service | \$12,400.00 | \$12,400.00 | \$18,000.00 | \$18,000.00 | \$8,000.00 | \$8,000.00 | \$8,598.00 | \$8,598.00 |
| 25. | 1,500 | L.F. | 8 Inch PVC Water Main | \$82.00 | \$123,000.00 | \$96.00 | \$144,000.00 | \$91.00 | \$136,500.00 | \$142.00 | \$213,000.00 |
| 26. | 90 | L.F. | 6 Inch PVC Water Main | \$101.00 | \$9,090.00 | \$90.00 | \$8,100.00 | \$125.00 | \$11,250.00 | \$136.00 | \$12,240.00 |
| 27. | 7 | Ea. | 8 Inch Valve | \$2,861.00 | \$20,027.00 | \$2,975.00 | \$20,825.00 | \$3,350.00 | \$23,450.00 | \$3,369.00 | \$23,583.00 |
| 28. | 4 | Ea. | 6 Inch Valve | \$2,076.00 | \$8,304.00 | \$2,130.00 | \$8,520.00 | \$2,400.00 | \$9,600.00 | \$2,416.00 | \$9,664.00 |
| 29. | 4 | Ea. | 7.5 Foot Bury Hydrant | \$6,100.00 | \$24,400.00 | \$6,450.00 | \$25,800.00 | \$7,200.00 | \$28,800.00 | \$7,168.00 | \$28,672.00 |
| 30. | 3 | Ea. | Salvage Existing Hydrant | \$500.00 | \$1,500.00 | \$750.00 | \$2,250.00 | \$350.00 | \$1,050.00 | \$1,166.00 | \$3,498.00 |
| 31. | 910 | L.F. | 1 Inch Water Service - Excavated | \$63.00 | \$57,330.00 | \$65.00 | \$59,150.00 | \$68.00 | \$61,880.00 | \$96.00 | \$87,360.00 |
| 32. | 30 | Ea. | 1 Inch Service Set | \$525.00 | \$15,750.00 | \$560.00 | \$16,800.00 | \$540.00 | \$16,200.00 | \$1,077.00 | \$32,310.00 |
| 33. | 20 | L.F. | 1-1/2 Inch Water Service - Excavated | \$70.00 | \$1,400.00 | \$66.00 | \$1,320.00 | \$68.00 | \$1,360.00 | \$97.00 | \$1,940.00 |
| 34. | 1 | Ea. | 1-1/2 Inch Water Service Set | \$985.00 | \$985.00 | \$1,072.00 | \$1,072.00 | \$1,150.00 | \$1,150.00 | \$1,654.00 | \$1,654.00 |
| 35. | 1 | L.S. | Water Main Trench Compaction and Certification | \$2,750.00 | \$2,750.00 | \$4,815.00 | \$4,815.00 | \$4,700.00 | \$4,700.00 | \$4,962.00 | \$4,962.00 |
| SUB-TOTAL (Items 23. through 35., Inclusive) | | | | \$279,215.34 | | \$318,652.00 | | \$305,140.00 | | \$432,889.00 | |

BID TABULATION

OWNER: VILLAGE OF KIMBERLY
Project Name: 2026 Utility Reconstruction
 Schindler Drive, Fulcer Avenue and Pine/Walnut Alley
 K0001-09-25-00632
Contract No. K0001-09-25-00632
Bid Date/Time: February 20, 2026 @ 10:00 a.m.
Project Manager: Brad Werner, PE

Engineer: McMAHON ASSOCIATES, INC.
 1445 McMahon Drive
 PO Box 1025
 Neenah, WI 54956 / 54957-1025

DONALD HIETPAS & SONS, INC.
 1450 E. North Avenue
 PO Box 166
 Little Chute, WI 54140

DAVID TENOR CORPORATION
 1651 Brookfield Avenue, Suite 12
 Green Bay, WI 54313

KRUCZEK CONSTRUCTION, INC.
 3636 Kewaunee Road
 Green Bay, WI 54311

DORNER, INC.
 E506 Luxemburg Road
 PO Box 129
 Luxemburg, WI 54217

STORM SEWER | Schindler Drive and Fulcer Avenue

| Item | Qty | Unit | Description | Unit Price | Total | Unit Price | Total | Unit Price | Total | Unit Price | Total |
|---|-----|------|---|---------------------|-------------|---------------------|-------------|---------------------|-------------|---------------------|-------------|
| 36. | 1 | L.S. | Mobilization / Bonding | \$2,279.34 | \$2,279.34 | \$1,000.00 | \$1,000.00 | \$1,200.00 | \$1,200.00 | \$5,408.00 | \$5,408.00 |
| 37. | 45 | V.F. | 4 Foot Diameter Storm Manhole | \$545.50 | \$24,547.50 | \$525.00 | \$23,625.00 | \$550.00 | \$24,750.00 | \$685.00 | \$30,825.00 |
| 38. | 4 | Ea. | Storm Manhole Casting | \$625.00 | \$2,500.00 | \$590.00 | \$2,360.00 | \$675.00 | \$2,700.00 | \$487.00 | \$1,948.00 |
| 39. | 8 | Ea. | Inlet with Casting and Drain Tile Stubs | \$3,500.00 | \$28,000.00 | \$4,110.00 | \$32,880.00 | \$3,900.00 | \$31,200.00 | \$3,562.00 | \$28,496.00 |
| 40. | 1 | Ea. | 3 Foot Diameter Yard Drain with Casting | \$3,800.00 | \$3,800.00 | \$2,840.00 | \$2,840.00 | \$3,200.00 | \$3,200.00 | \$3,399.00 | \$3,399.00 |
| 41. | 448 | L.F. | 21 Inch PVC Storm Sewer | \$124.50 | \$55,776.00 | \$121.00 | \$54,208.00 | \$146.00 | \$65,408.00 | \$163.00 | \$73,024.00 |
| 42. | 658 | L.F. | 18 Inch PVC Storm Sewer | \$104.00 | \$68,432.00 | \$107.00 | \$70,406.00 | \$130.00 | \$85,540.00 | \$142.00 | \$93,436.00 |
| 43. | 172 | L.F. | 12 Inch PVC Storm Sewer | \$65.00 | \$11,180.00 | \$89.00 | \$15,308.00 | \$92.00 | \$15,824.00 | \$108.00 | \$18,576.00 |
| 44. | 8 | L.F. | 12 Inch RCP Class III Concrete Storm Sewer | \$130.00 | \$1,040.00 | \$112.00 | \$896.00 | \$141.00 | \$1,128.00 | \$129.00 | \$1,032.00 |
| 45. | 9 | Ea. | 4 Inch Storm Lateral Inserta Tee Connection to 18 Inch PVC Main | \$280.00 | \$2,520.00 | \$415.00 | \$3,735.00 | \$550.00 | \$4,950.00 | \$796.00 | \$7,164.00 |
| 46. | 380 | L.F. | 4 Inch Storm Sewer Lateral (Public) | \$59.00 | \$22,420.00 | \$48.00 | \$18,240.00 | \$40.00 | \$15,200.00 | \$59.00 | \$22,420.00 |
| 47. | 200 | L.F. | 4 Inch Storm Sewer Lateral (Private) with Turf Restoration | \$40.00 | \$8,000.00 | \$55.00 | \$11,000.00 | \$49.00 | \$9,800.00 | \$55.00 | \$11,000.00 |
| 48. | 5 | Ea. | Collection Riser at House (Private) | \$200.00 | \$1,000.00 | \$275.00 | \$1,375.00 | \$300.00 | \$1,500.00 | \$293.00 | \$1,465.00 |
| 49. | 1 | L.S. | Storm Sewer Clean and Televising | \$1,753.47 | \$1,753.47 | \$1,788.00 | \$1,788.00 | \$2,400.00 | \$2,400.00 | \$2,323.00 | \$2,323.00 |
| 50. | 15 | Ea. | Post Construction Storm Lateral Televising | \$98.98 | \$1,484.70 | \$101.00 | \$1,515.00 | \$110.00 | \$1,650.00 | \$116.00 | \$1,740.00 |
| 51. | 1 | L.S. | Storm Sewer Trench Compaction and Certification | \$2,750.00 | \$2,750.00 | \$31.26 | \$31.26 | \$5,100.00 | \$5,100.00 | \$5,279.00 | \$5,279.00 |
| SUB-TOTAL (Items 36. through 51., Inclusive) | | | | \$237,483.01 | | \$241,207.26 | | \$271,550.00 | | \$307,535.00 | |

MISCELLANEOUS | Schindler Drive and Fulcer Avenue

| Item | Qty | Unit | Description | Unit Price | Total | Unit Price | Total | Unit Price | Total | Unit Price | Total |
|---|-----|------|---|--------------------|-------------|---------------------|-------------|--------------------|-------------|--------------------|-------------|
| 52. | 10 | Ea. | Erosion Control - Inlet Protection and Maintenance | \$100.00 | \$1,000.00 | \$80.00 | \$800.00 | \$100.00 | \$1,000.00 | \$150.00 | \$1,500.00 |
| 53. | 1 | L.S. | Concrete Street Pavement Removal (Approx. 5,400 S.Y.) | \$27,062.15 | \$27,062.15 | \$87,157.00 | \$87,157.00 | \$32,000.00 | \$32,000.00 | \$20,440.00 | \$20,440.00 |
| 54. | 1 | L.S. | Rough Grading Terraces | \$2,000.00 | \$2,000.00 | \$15,250.00 | \$15,250.00 | \$5,000.00 | \$5,000.00 | \$5,000.00 | \$5,000.00 |
| 55. | 3 | Ea. | Tree Removal (24 Inch Diameter) | \$1,111.00 | \$3,333.00 | \$1,133.00 | \$3,399.00 | \$1,200.00 | \$3,600.00 | \$1,161.00 | \$3,483.00 |
| 56. | 30 | Ea. | Remove Mailbox | \$55.00 | \$1,650.00 | \$50.00 | \$1,500.00 | \$60.00 | \$1,800.00 | \$50.00 | \$1,500.00 |
| 57. | 30 | Ea. | Temporary Mailbox at Fulcer Avenue Parking Lot | \$60.00 | \$1,800.00 | \$50.00 | \$1,500.00 | \$40.00 | \$1,200.00 | \$50.00 | \$1,500.00 |
| 58. | 50 | L.F. | 18 Inch Concrete Curb and Gutter | \$72.72 | \$3,636.00 | \$78.00 | \$3,900.00 | \$91.00 | \$4,550.00 | \$76.01 | \$3,800.50 |
| 59. | 175 | S.Y. | Roger Street 3 Inch 3 LT 58-28 S Asphalt Binder | \$30.35 | \$5,311.25 | \$31.26 | \$5,470.50 | \$31.00 | \$5,425.00 | \$32.04 | \$5,607.00 |
| SUB-TOTAL (Items 52. through 59., Inclusive) | | | | \$45,792.40 | | \$118,976.50 | | \$54,575.00 | | \$42,830.50 | |

SANITARY SEWER | Pine Street/Walnut Street Alley

| Item | Qty | Unit | Description | Unit Price | Total | Unit Price | Total | Unit Price | Total | Unit Price | Total |
|------|-----|------|---|------------|-------------|------------|-------------|------------|-------------|------------|--------------|
| 60. | 1 | L.S. | Mobilization / Bonding | \$1,000.00 | \$1,000.00 | \$2,000.00 | \$2,000.00 | \$3,000.00 | \$3,000.00 | \$5,408.00 | \$5,408.00 |
| 61. | 951 | L.F. | 8 Inch SDR 35 PVC Sanitary Sewer with Special Backfill | \$85.85 | \$81,643.35 | \$88.00 | \$83,688.00 | \$102.00 | \$97,002.00 | \$144.00 | \$136,944.00 |
| 62. | 80 | L.F. | 4 Inch Sanitary Lateral - Excavated | \$101.00 | \$8,080.00 | \$103.00 | \$8,240.00 | \$104.00 | \$8,320.00 | \$97.00 | \$7,760.00 |
| 63. | 210 | L.F. | 4 Inch HDPE DR 17 Sanitary Lateral - Pipe Burst in Right-of-Way | \$5.10 | \$1,071.00 | \$5.15 | \$1,081.50 | \$5.00 | \$1,050.00 | \$5.28 | \$1,108.80 |
| 64. | 31 | Ea. | 4" x 8" Wye Connection Including Riser | \$2,040.00 | \$63,240.00 | \$2,060.00 | \$63,860.00 | \$2,070.00 | \$64,170.00 | \$223.00 | \$6,913.00 |
| 65. | 45 | V.F. | 48 Inch Sanitary Manhole | \$520.00 | \$23,400.00 | \$584.00 | \$26,280.00 | \$755.00 | \$33,975.00 | \$597.00 | \$26,865.00 |
| 66. | 4 | Ea. | Manhole Casting | \$650.00 | \$2,600.00 | \$575.00 | \$2,300.00 | \$625.00 | \$2,500.00 | \$270.00 | \$1,080.00 |
| 67. | 1 | L.S. | Remove Sanitary Manhole on 3rd Street | \$5,050.00 | \$5,050.00 | \$5,150.00 | \$5,150.00 | \$5,500.00 | \$5,500.00 | \$8,198.00 | \$8,198.00 |
| 67. | 1 | L.S. | Post Construction Mainline Cleaning and Televising (Approx. 1,031 L.F.) | \$1,405.77 | \$1,405.77 | \$1,434.00 | \$1,434.00 | \$1,900.00 | \$1,900.00 | \$1,789.00 | \$1,789.00 |
| 69. | 34 | Ea. | Post Construction Lateral Televising | \$98.98 | \$3,365.32 | \$101.00 | \$3,434.00 | \$125.00 | \$4,250.00 | \$116.00 | \$3,944.00 |
| 70. | 1 | L.S. | Sanitary Sewer Trench Compaction and Certification | \$2,750.00 | \$2,750.00 | \$8,725.00 | \$8,725.00 | \$8,835.00 | \$8,835.00 | \$8,974.00 | \$8,974.00 |

BID TABULATION

OWNER: VILLAGE OF KIMBERLY
Project Name: 2026 Utility Reconstruction
 Schindler Drive, Fulcer Avenue and Pine/Walnut Alley
 K0001-09-25-00632
Contract No. K0001-09-25-00632
Bid Date/Time: February 20, 2026 @ 10:00 a.m.
Project Manager: Brad Werner, PE

Engineer: McMAHON ASSOCIATES, INC.
 1445 McMahan Drive
 PO Box 1025
 Neenah, WI 54956 / 54957-1025

DONALD HIETPAS & SONS, INC.
 1450 E. North Avenue
 PO Box 166
 Little Chute, WI 54140

DAVID TENOR CORPORATION
 1651 Brookfield Avenue, Suite 12
 Green Bay, WI 54313

KRUCZEK CONSTRUCTION, INC.
 3636 Kewaunee Road
 Green Bay, WI 54311

DORNER, INC.
 E506 Luxemburg Road
 PO Box 129
 Luxemburg, WI 54217

SANITARY SEWER | Pine Street/Walnut Street Alley

| Item | Qty | Unit | Description | Unit Price | Total | Unit Price | Total | Unit Price | Total | Unit Price | Total |
|---|-------|------|---|---------------------|-------------|---------------------|-------------|---------------------|-------------|---------------------|-------------|
| 71. | 2,170 | L.F. | 4 Inch HDPE DR 17 Sanitary Lateral - Pipe Burst | \$5.05 | \$10,958.50 | \$5.10 | \$11,067.00 | \$5.00 | \$10,850.00 | \$5.28 | \$11,457.60 |
| 72. | 10 | Ea. | Outside Spot Excavation | \$505.00 | \$5,050.00 | \$510.00 | \$5,100.00 | \$500.00 | \$5,000.00 | \$528.00 | \$5,280.00 |
| 73. | 2 | Ea. | Outside Cleanout with Frost Sleeve | \$252.50 | \$505.00 | \$255.00 | \$510.00 | \$350.00 | \$700.00 | \$264.00 | \$528.00 |
| 74. | 30 | Ea. | Pipe Burst Set Up Fee | \$3,030.00 | \$90,900.00 | \$3,075.00 | \$92,250.00 | \$3,050.00 | \$91,500.00 | \$3,167.00 | \$95,010.00 |
| 75. | 60 | Ea. | 4 Inch Furnco Connection | \$25.25 | \$1,515.00 | \$26.00 | \$1,560.00 | \$25.50 | \$1,530.00 | \$26.00 | \$1,560.00 |
| 76. | 60 | Ea. | 4 Inch Bend | \$20.20 | \$1,212.00 | \$21.00 | \$1,260.00 | \$20.00 | \$1,200.00 | \$21.00 | \$1,260.00 |
| 77. | 30 | Ea. | Inside Cleanout | \$50.50 | \$1,515.00 | \$51.00 | \$1,530.00 | \$50.00 | \$1,500.00 | \$53.00 | \$1,590.00 |
| 78. | 30 | Ea. | Cleanout Cap | \$10.10 | \$303.00 | \$11.00 | \$330.00 | \$10.00 | \$300.00 | \$11.00 | \$330.00 |
| 79. | 30 | Ea. | Floor Drain | \$101.00 | \$3,030.00 | \$103.00 | \$3,090.00 | \$100.00 | \$3,000.00 | \$106.00 | \$3,180.00 |
| 80. | 125 | BAG | Redi-Crete Floor Restoration | \$20.20 | \$2,525.00 | \$21.00 | \$2,625.00 | \$20.00 | \$2,500.00 | \$21.00 | \$2,625.00 |
| 81. | 1 | Ea. | CIPP Liner Set Up Cost | \$1,262.50 | \$1,262.50 | \$1,287.50 | \$1,287.50 | \$1,325.00 | \$1,325.00 | \$1,320.00 | \$1,320.00 |
| 82. | 80 | L.F. | 4 Inch CIPP Liner | \$75.75 | \$6,060.00 | \$77.25 | \$6,180.00 | \$76.50 | \$6,120.00 | \$79.18 | \$6,334.40 |
| SUB-TOTAL (Items 60. through 82., Inclusive) | | | | \$318,441.44 | | \$332,982.00 | | \$356,027.00 | | \$339,458.80 | |

STORM SEWER | Pine Street/Walnut Street Alley

| Item | Qty | Unit | Description | Unit Price | Total | Unit Price | Total | Unit Price | Total | Unit Price | Total |
|---|-----|------|--|--------------------|-------------|--------------------|-------------|--------------------|-------------|--------------------|-------------|
| 83. | 1 | L.S. | Mobilization / Bonding | \$1,000.00 | \$1,000.00 | \$1,000.00 | \$1,000.00 | \$3,000.00 | \$3,000.00 | \$5,408.00 | \$5,408.00 |
| 84. | 2 | Ea. | Inlet with Casting and Drain Tile Stubs | \$3,800.00 | \$7,600.00 | \$4,110.00 | \$8,220.00 | \$4,225.00 | \$8,450.00 | \$3,408.00 | \$6,816.00 |
| 85. | 196 | L.F. | 12 Inch Storm Sewer with Special Backfill | \$75.00 | \$14,700.00 | \$96.00 | \$18,816.00 | \$92.00 | \$18,032.00 | \$114.00 | \$22,344.00 |
| 86. | 1 | L.S. | Storm Sewer Clean and Televis (Approx. 196 L.F.) | \$266.64 | \$266.64 | \$272.00 | \$272.00 | \$750.00 | \$750.00 | \$792.00 | \$792.00 |
| 87. | 1 | L.S. | Storm Sewer Trench Compaction and Certification | \$2,750.00 | \$2,750.00 | \$725.00 | \$725.00 | \$750.00 | \$750.00 | \$739.00 | \$739.00 |
| SUB-TOTAL (Items 83. through 87., Inclusive) | | | | \$26,316.64 | | \$29,033.00 | | \$30,982.00 | | \$36,099.00 | |

ALLEY RECONSTRUCTION/RESTORATION

| Item | Qty | Unit | Description | Unit Price | Total | Unit Price | Total | Unit Price | Total | Unit Price | Total |
|--|-------|------|--|---------------------|-------------|---------------------|-------------|---------------------|-------------|---------------------|-------------|
| 88. | 1 | L.S. | Mobilization / Bonding | \$500.00 | \$500.00 | \$775.00 | \$775.00 | \$3,000.00 | \$3,000.00 | \$8,047.00 | \$8,047.00 |
| 89. | 1 | L.S. | Unclassified Excavation (Est. 930 C.Y.) | \$31,080.20 | \$31,080.20 | \$19,000.00 | \$19,000.00 | \$35,000.00 | \$35,000.00 | \$30,157.00 | \$30,157.00 |
| 90. | 1,450 | S.Y. | Tensar H-Series HX5.5 Geogrid | \$5.50 | \$7,975.00 | \$3.58 | \$5,191.00 | \$5.00 | \$7,250.00 | \$1.58 | \$2,291.00 |
| 91. | 1,450 | S.Y. | New 12 Inch WisDOT 1-1/4 Inch Base Aggregate Dense | \$18.70 | \$27,115.00 | \$13.68 | \$19,836.00 | \$19.75 | \$28,637.50 | \$15.84 | \$22,968.00 |
| 92. | 1,650 | S.Y. | 2-1/4 Inch WisDOT 3 LT 58-28 S Asphalt Binder (Alley and Driveways) | \$15.89 | \$26,218.50 | \$16.37 | \$27,010.50 | \$16.25 | \$26,812.50 | \$16.78 | \$27,687.00 |
| 93. | 1,650 | S.Y. | 1-3/4 Inch WisDOT 4 LT 58-28 S Asphalt Surface (Alley and Driveways) | \$10.25 | \$16,912.50 | \$10.56 | \$17,424.00 | \$10.50 | \$17,325.00 | \$10.82 | \$17,853.00 |
| 94. | 1,100 | L.F. | 18 Inch Concrete Curb and Gutter | \$17.75 | \$19,525.00 | \$22.00 | \$24,200.00 | \$18.55 | \$20,405.00 | \$18.55 | \$20,405.00 |
| 95. | 50 | L.F. | 30 Inch Concrete Curb and Gutter | \$54.50 | \$2,725.00 | \$60.00 | \$3,000.00 | \$71.00 | \$3,550.00 | \$57.01 | \$2,850.50 |
| 96. | 1,200 | S.F. | Remove and Replace 6 Inch Concrete Sidewalk/Driveway/Street Pavement | \$12.40 | \$14,880.00 | \$10.00 | \$12,000.00 | \$14.00 | \$16,800.00 | \$11.09 | \$13,308.00 |
| 97. | 540 | S.F. | 8 Inch Concrete Apron/Sidewalk/Street Pavement | \$12.46 | \$6,728.40 | \$11.00 | \$5,940.00 | \$15.00 | \$8,100.00 | \$11.09 | \$5,988.60 |
| 98. | 100 | Ea. | #6 Epoxy Coated Tie Bars Drilled and Set | \$9.09 | \$909.00 | \$9.30 | \$930.00 | \$9.00 | \$900.00 | \$9.50 | \$950.00 |
| 99. | 1,000 | S.Y. | Turf Restoration | \$7.88 | \$7,880.00 | \$6.95 | \$6,950.00 | \$10.00 | \$10,000.00 | \$14.25 | \$14,250.00 |
| 100. | 1 | Ea. | Stop Sign with Mounting Post | \$232.30 | \$232.30 | \$258.00 | \$258.00 | \$300.00 | \$300.00 | \$1,500.00 | \$1,500.00 |
| 101. | 1 | Ea. | Remove 24 Inch Tree and Stump (3rd Street) | \$1,111.00 | \$1,111.00 | \$1,033.00 | \$1,033.00 | \$2,000.00 | \$2,000.00 | \$1,161.00 | \$1,161.00 |
| SUB-TOTAL (Items 88. through 101., Inclusive) | | | | \$163,791.90 | | \$143,547.50 | | \$180,080.00 | | \$169,416.10 | |

BID TABULATION

OWNER: VILLAGE OF KIMBERLY
Project Name: 2026 Utility Reconstruction
 Schindler Drive, Fulcer Avenue and Pine/Walnut Alley
 K0001-09-25-00632
Contract No. K0001-09-25-00632
Bid Date/Time: February 20, 2026 @ 10:00 a.m.
Project Manager: Brad Werner, PE

Engineer: McMAHON ASSOCIATES, INC.
 1445 McMahan Drive
 PO Box 1025
 Neenah, WI 54956 / 54957-1025

DONALD HIETPAS & SONS, INC.
 1450 E. North Avenue
 PO Box 166
 Little Chute, WI 54140

DAVID TENOR CORPORATION
 1651 Brookfield Avenue, Suite 12
 Green Bay, WI 54313

KRUCZEK CONSTRUCTION, INC.
 3636 Kewaunee Road
 Green Bay, WI 54311

DORNER, INC.
 E506 Luxemburg Road
 PO Box 129
 Luxemburg, WI 54217

KIMBERLY AVENUE PARKING LOT

| Item | Qty | Unit | Description | Unit Price | Total | Unit Price | Total | Unit Price | Total | Unit Price | Total |
|---|-----|------|---|-----------------------|-------------|-----------------------|-------------|-----------------------|-------------|-----------------------|-------------|
| 102. | 1 | L.S. | Mobilization / Bonding | \$500.00 | \$500.00 | \$775.00 | \$775.00 | \$3,000.00 | \$3,000.00 | \$8,047.00 | \$8,047.00 |
| 103. | 1 | L.S. | Unclassified Excavation (Est. 400 C.Y.) | \$23,481.75 | \$23,481.75 | \$8,200.00 | \$8,200.00 | \$27,000.00 | \$27,000.00 | \$13,962.00 | \$13,962.00 |
| 104. | 670 | S.Y. | Tensar H-Series HX55 Geogrid | \$4.75 | \$3,182.50 | \$3.58 | \$2,398.60 | \$5.00 | \$3,350.00 | \$1.58 | \$1,058.60 |
| 105. | 670 | S.Y. | New 12 Inch WisDOT 1-1/4 Inch Base Aggregate Dense | \$16.25 | \$10,887.50 | \$12.80 | \$8,576.00 | \$16.75 | \$11,222.50 | \$18.37 | \$12,307.90 |
| 106. | 657 | S.Y. | 1-3/4 Inch WisDOT 3 LT 58-28 S Asphalt Binder | \$15.25 | \$10,019.25 | \$15.71 | \$10,321.47 | \$15.50 | \$10,183.50 | \$16.10 | \$10,577.70 |
| 107. | 657 | L.F. | 1-3/4 Inch WisDOT 4 LT 58-28 S Asphalt Surface | \$13.17 | \$8,652.69 | \$13.57 | \$8,915.49 | \$13.50 | \$8,869.50 | \$13.90 | \$9,132.30 |
| 108. | 23 | L.F. | Remove and Replace 30 Inch Curb and Gutter (Including Sawcut) | \$91.27 | \$2,099.21 | \$78.00 | \$1,794.00 | \$125.00 | \$2,875.00 | \$86.89 | \$1,998.47 |
| 109. | 170 | S.F. | Remove and Replace 4 Inch Concrete Sidewalk | \$15.97 | \$2,714.90 | \$12.62 | \$2,145.40 | \$18.00 | \$3,060.00 | \$14.78 | \$2,512.60 |
| 110. | 209 | S.F. | 6 Inch Concrete Apron/Sidewalk | \$16.65 | \$3,479.85 | \$15.71 | \$3,283.39 | \$19.00 | \$3,971.00 | \$15.84 | \$3,310.56 |
| 111. | 765 | L.F. | 4 Inch White Epoxy Pavement Marking | \$5.81 | \$4,444.65 | \$5.92 | \$4,528.80 | \$5.50 | \$4,207.50 | \$6.07 | \$4,643.55 |
| 112. | 1 | Ea. | Epoxy Accessible Stall Symbol | \$176.75 | \$176.75 | \$180.00 | \$180.00 | \$200.00 | \$200.00 | \$185.00 | \$185.00 |
| 113. | 1 | Ea. | Epoxy "Arrow" and "Only" | \$525.20 | \$525.20 | \$536.00 | \$536.00 | \$610.00 | \$610.00 | \$549.00 | \$549.00 |
| 114. | 1 | L.S. | Furnish and Install Signs with Posts (See Sign Key Sheet 14) | \$1,717.00 | \$1,717.00 | \$1,805.00 | \$1,805.00 | \$3,100.00 | \$3,100.00 | \$1,500.00 | \$1,500.00 |
| 115. | 270 | S.Y. | Turf Restoration | \$10.00 | \$2,700.00 | \$6.95 | \$1,876.50 | \$10.00 | \$2,700.00 | \$16.89 | \$4,560.30 |
| SUB-TOTAL (Items 102. through 115., Inclusive) | | | | \$74,581.25 | | \$55,335.65 | | \$84,349.00 | | \$74,344.98 | |
| TOTAL (Items 1. through 115., Inclusive) | | | | \$1,399,913.40 | | \$1,518,108.41 | | \$1,555,555.00 | | \$1,726,637.18 | |

ALTERNATE BID A

| Item | Qty | Unit | Description | Unit Price | Total | Unit Price | Total | Unit Price | Total | Unit Price | Total |
|---|-----|------|---------------------------------|--------------------|------------|--------------------|------------|--------------------|-------------|--------------------|------------|
| A-1 | 10 | Ea. | 20 Inch to 24 Inch Tree Removal | \$670.00 | \$6,700.00 | \$670.00 | \$6,700.00 | \$1,000.00 | \$10,000.00 | \$686.00 | \$6,860.00 |
| A-2 | 11 | Ea. | 15Inch to 18 Inch Tree Removal | \$560.00 | \$6,160.00 | \$567.00 | \$6,237.00 | \$800.00 | \$8,800.00 | \$581.00 | \$6,391.00 |
| TOTAL (Items A-1 through A-2, Inclusive) | | | | \$12,860.00 | | \$12,937.00 | | \$18,800.00 | | \$13,251.00 | |

| | | | | |
|--------------------------|-----------------|-----------------|-----------------|-----------------|
| Bid Security | 5% Bid Bond | 5% Bid Bond | 5% Bid Bond | 5% Bid Bond |
| Addendum Acknowledgement | Yes - #1 and #2 | Yes - #1 and #2 | Yes - #1 and #2 | Yes - #1 and #2 |

| | Subcontractor | Subcontractor | Subcontractor | Subcontractor |
|------------------------------------|----------------------------|-------------------|-------------------------------|-------------------|
| Pipe Bursting | M&E Construction | M&E Construction | M&E Construction | M&E Construction |
| Concrete Repair | Jim Fischer, Inc. | Jim Fischer, Inc. | Jim Fischer, Inc. | Jim Fischer, Inc. |
| Televising | Speedy Clean | N/A | N/A | Great Lakes |
| Grade & Gravel - Street Excavation | MCC | N/A | N/A | N/A |
| Asphalt | MCC | MCC | MCC | MCC |
| Traffic Control | Gordon Work Zone | N/A | N/A | N/A |
| Compaction Testing | ECS Midwest | N/A | Bay Area Testing & Consulting | Bay Area Testing |
| Terrace Restoration | Pleasant Knoll Landscaping | N/A | N/A | N/A |
| Clearing & Grubbing | N/A | N/A | On-Site Logging | On-Site Logging |
| Pavement Marking | N/A | N/A | Century Traffic | Century Traffic |

BID TABULATION

OWNER: VILLAGE OF KIMBERLY
Project Name: 2026 Street Reconstruction | Schindler Drive & Fulcer Avenue
Contract No.: K0001-09-25-00633
Bid Date/Time: February 25, 2026 @ 10:00 a.m., local time
Project Manager: Brad Werner, PE

Engineer: McMAHON ASSOCIATES, INC.
 1445 McMahan Drive
 PO Box 1025
 Neenah, WI 54956 / 54957-1025

VINTON CONSTRUCTION CO.
 1322 33rd Street
 PO Box 137
 Two Rivers, WI 54241

SOMMERS CONSTRUCTION CO., INC.
 W7841 Smith Street
 Shiocton, WI 54170

ZIGNEGO COMPANY, INC.
 N35 W23877 Highfield Ct, Suite 200
 Pewaukee, WI 53072

BASE BID | Schindler Drive / Fulcer Avenue

| Item | Qty | Unit | Description | Unit Price | Total | Unit Price | Total | Unit Price | Total |
|--|-------|------|---|---------------------|--------------|---------------------|--------------|---------------------|--------------|
| 1. | 1 | L.S. | Mobilization and Bonding | \$29,550.00 | \$29,550.00 | \$59,500.00 | \$59,500.00 | \$75,000.00 | \$75,000.00 |
| 2. | 1 | L.S. | Unclassified Excavation (Est. 2,100 C.Y.) | \$48,300.00 | \$48,300.00 | \$44,940.00 | \$44,940.00 | \$39,041.50 | \$39,041.50 |
| 3. | 2,790 | L.F. | 30 Inch Concrete Curb and Gutter | \$17.60 | \$49,104.00 | \$21.90 | \$61,101.00 | \$22.00 | \$61,380.00 |
| 4. | 4,435 | S.Y. | 6 Inch Concrete Pavement | \$49.66 | \$220,242.10 | \$59.35 | \$263,217.25 | \$51.61 | \$228,890.35 |
| 5. | 5,518 | S.Y. | 8 Inch Road Base Course | \$6.50 | \$35,867.00 | \$8.95 | \$49,386.10 | \$8.35 | \$46,075.30 |
| 6. | 200 | C.Y. | EBS Including Base Course | \$61.00 | \$12,200.00 | \$0.01 | \$2.00 | \$51.00 | \$10,200.00 |
| 7. | 5,860 | S.F. | Remove and Replace 6 Inch Concrete Apron / Sidewalk with Base | \$9.60 | \$56,256.00 | \$8.75 | \$51,275.00 | \$11.70 | \$68,562.00 |
| 8. | 3,916 | S.F. | Remove and Replace 4 Inch Concrete Sidewalk with Base | \$8.45 | \$33,090.20 | \$7.90 | \$30,936.40 | \$9.30 | \$36,418.80 |
| 9. | 66 | L.F. | Full Depth Sawcut Existing Concrete Pavement | \$3.00 | \$198.00 | \$5.00 | \$330.00 | \$1.95 | \$128.70 |
| 10. | 30 | Ea. | #6 Epoxy Coated Tie Bars Drilled and Set | \$9.00 | \$270.00 | \$10.00 | \$300.00 | \$50.00 | \$1,500.00 |
| 11. | 20 | S.Y. | Detectable Warning Field - Petina | \$33.00 | \$660.00 | \$35.00 | \$700.00 | \$40.00 | \$800.00 |
| 12. | 2,340 | S.Y. | 3 Inch Pulverized Topsoil, Seed Mix #4 and Hydromulch | \$9.75 | \$22,815.00 | \$4.65 | \$10,881.00 | \$9.25 | \$21,645.00 |
| 13. | 3 | Ea. | Stump Removal | \$300.00 | \$900.00 | \$100.00 | \$300.00 | \$244.10 | \$732.30 |
| 14. | 10 | Ea. | Inlet Protection Maintenance | \$50.00 | \$500.00 | \$1.00 | \$10.00 | \$64.45 | \$644.50 |
| 15. | 4 | Ea. | Internal Chimney Seal | \$600.00 | \$2,400.00 | \$750.00 | \$3,000.00 | \$1,000.00 | \$4,000.00 |
| 16. | 8 | Ea. | Adjust Sanitary and Storm Manhole Castings | \$250.00 | \$2,000.00 | \$800.00 | \$6,400.00 | \$600.00 | \$4,800.00 |
| 17. | 10 | Ea. | Adjust Inlet Casting | \$250.00 | \$2,500.00 | \$700.00 | \$7,000.00 | \$800.00 | \$8,000.00 |
| 18. | 8 | Ea. | Adjust Water Valve Box | \$250.00 | \$2,000.00 | \$200.00 | \$1,600.00 | \$1,000.00 | \$8,000.00 |
| 19. | 30 | Ea. | Install Mailbox Provided by Homeowner | \$60.00 | \$1,800.00 | \$30.00 | \$900.00 | \$63.30 | \$1,899.00 |
| 20. | 30 | Ea. | Furnish and Install Treated 4" x 4" Mailbox Post | \$40.00 | \$1,200.00 | \$100.00 | \$3,000.00 | \$41.45 | \$1,243.50 |
| 21. | 8 | Ea. | Greenspace Linden (1.5" - 2", Balled and Burlapped) | \$360.00 | \$2,880.00 | \$1,250.00 | \$10,000.00 | \$663.75 | \$5,310.00 |
| 22. | 5 | Ea. | Patriot Elm (1.5" - 2", Balled and Burlapped) | \$350.00 | \$1,750.00 | \$1,250.00 | \$6,250.00 | \$653.40 | \$3,267.00 |
| 23. | 2 | Ea. | Autumn Fantasy Maple (1.5" - 2", Balled and Burlapped) | \$400.00 | \$800.00 | \$1,250.00 | \$2,500.00 | \$658.00 | \$1,316.00 |
| 24. | 2 | Ea. | Furnish and Install Street Sign and Post | \$224.00 | \$448.00 | \$250.00 | \$500.00 | \$362.40 | \$724.80 |
| SUB-TOTAL (Items 1. through 24., Inclusive) | | | | \$527,730.30 | | \$614,028.75 | | \$629,578.75 | |

BASE BID | Fulcer Avenue Street Patching

| Item | Qty | Unit | Description | Unit Price | Total | Unit Price | Total | Unit Price | Total |
|---|-----|------|--|---------------------|-------------|---------------------|-------------|---------------------|-------------|
| 25. | 370 | S.Y. | Remove and Replace a 6 Inch Concrete Pavement with New 8 Inch C.A.B.C. | \$98.72 | \$36,526.40 | \$89.00 | \$32,930.00 | \$122.00 | \$45,140.00 |
| 26. | 345 | S.F. | 6 Inch Concrete Apron | \$10.00 | \$3,450.00 | \$9.00 | \$3,105.00 | \$9.10 | \$3,139.50 |
| 27. | 235 | L.F. | Full Depth Sawcut Concrete Pavement | \$3.00 | \$705.00 | \$3.50 | \$822.50 | \$1.95 | \$458.25 |
| 28. | 900 | L.F. | 1-1/2 Inch Deep Sawcut with Joint Sealer | \$3.00 | \$2,700.00 | \$6.00 | \$5,400.00 | \$5.00 | \$4,500.00 |
| 29. | 2 | Ea. | Adjust Inlet with New Rings | \$250.00 | \$500.00 | \$850.00 | \$1,700.00 | \$1,000.00 | \$2,000.00 |
| 30. | 65 | S.Y. | 3 Inch Pulverized Topsoil, Seed Mix #4 and Hydromulch | \$12.75 | \$828.75 | \$4.65 | \$302.25 | \$11.15 | \$724.75 |
| 31. | 100 | Ea. | #6 Epoxy Coated Tie Bars Drilled and Set | \$5.00 | \$500.00 | \$10.00 | \$1,000.00 | \$30.00 | \$3,000.00 |
| SUB-TOTAL (Items 25. through 31., Inclusive) | | | | \$45,210.15 | | \$45,259.75 | | \$58,962.50 | |
| TOTAL (Items 1. through 31., Inclusive) | | | | \$572,940.45 | | \$659,288.50 | | \$688,541.25 | |

ALTERNATE BID A | Schindler Drive / Fulcer Avenue Integral Concrete Paving

BID TABULATION

OWNER: VILLAGE OF KIMBERLY
Project Name: 2026 Street Reconstruction | Schindler Drive & Fulcer Avenue
Contract No. K0001-09-25-00633
Bid Date/Time: February 25, 2026 @ 10:00 a.m., local time
Project Manager: Brad Werner, PE

Engineer: McMAHON ASSOCIATES, INC.
 1445 McMahon Drive
 PO Box 1025
 Neenah, WI 54956 / 54957-1025

VINTON CONSTRUCTION CO.
 1322 33rd Street
 PO Box 137
 Two Rivers, WI 54241

SOMMERS CONSTRUCTION CO., INC.
 W7841 Smith Street
 Shiocton, WI 54170

ZIGNEGO COMPANY, INC.
 N35 W23877 Highfield Ct, Suite 200
 Pewaukee, WI 53072

| Item | Qty | Unit | Description |
|------|-------|------|--|
| A-1 | 5,210 | S.Y. | 6 Inch Integral Concrete Street Pavement |
| A-2 | 5,828 | S.Y. | 8 Inch Road Base Course |
| A-3 | 11 | Ea. | Stump Removal (15" - 18") |
| A-4 | 10 | Ea. | Stump Removal (20" - 24") |

| Unit Price | Total |
|------------|--------------|
| \$51.30 | \$267,273.00 |
| \$6.50 | \$37,882.00 |
| \$350.00 | \$3,850.00 |
| \$400.00 | \$4,000.00 |

| Unit Price | Total |
|------------|--------------|
| \$59.35 | \$309,213.50 |
| \$8.95 | \$52,160.60 |
| \$100.00 | \$1,100.00 |
| \$100.00 | \$1,000.00 |

| Unit Price | Total |
|------------|--------------|
| \$54.00 | \$281,340.00 |
| \$8.85 | \$51,577.80 |
| \$122.75 | \$1,350.25 |
| \$135.05 | \$1,350.50 |

TOTAL ALTERNATE BID A (Items A-1 through A-4, Inclusive)

\$313,005.00

\$363,474.10

\$335,618.55

ALTERNATE BID B

| Item | Qty | Unit | Description |
|------|-----|------|---|
| B-1 | 1 | L.S. | Restore Roger Street Intersection 6 Inch Integral Concrete Pavement (Approx. 77 S.Y.) |

| Unit Price | Total |
|------------|------------|
| \$7,200.00 | \$7,200.00 |

| Unit Price | Total |
|------------|--------|
| \$0.00 | \$0.00 |

| Unit Price | Total |
|-------------|-------------|
| \$14,000.00 | \$14,000.00 |

| | | | |
|--------------|-------------|-------------|-------------|
| Bid Security | 5% Bid Bond | 5% Bid Bond | 5% Bid Bond |
|--------------|-------------|-------------|-------------|

*Ancillary Concrete
 Traffic Control
 Landscape, Clear/Grub
 Sawing*

Subcontractor
 Martell Construction, Inc.
 Barricade Flasher Service
 N/A
 N/A

Subcontractor
 N/A
 N/A
 Signature Landscape
 N/A

Subcontractor
 Al Dix Concrete
 Gordon Work Zones
 MCC, Inc.
 Hard Rock

SCHEDULE OF ASSESSMENTS

SCHINDLER DRIVE & FULCER AVENUE

VILLAGE OF KIMBERLY | OUTAGAMIE COUNTY, WISCONSIN



Estimated Lateral in R/W Assessment = \$826.91
 Estimated Average Cost of a Private Sanitary Lateral = \$3,540.05
 Estimated Storm Lateral Assessment = \$2,609.57
 Estimated Cost of a Private Storm Lateral = \$2,200.00
 Concrete Apron Assessment Rate (S.F.) = \$9.60

| Property Address | Mailing Address | Parcel No. | Estimated Sanitary Lateral In R/W Assessment | Estimated Private Sanitary Lateral Cost | Estimated Storm Lateral In R/W Assessment | Estimated Private Storm Lateral Cost | Estimated Apron Size (S.F.) | Estimated Apron Cost | Estimated Total Assessment |
|---------------------|--|------------|--|---|---|--------------------------------------|-----------------------------|----------------------|----------------------------|
| 303 SCHINDLER DR | N8949 W Shore Lane, St Cloud, WI 53079 | 250169600 | \$826.91 | \$3,540.05 | \$0.00 | \$2,200.00 ** | 182 | \$1,747.20 | \$8,314.16 |
| 304 SCHINDLER DR | | 250169700 | \$826.91 | \$3,540.05 | \$2,609.57 * | \$2,200.00 ** | 195 | \$1,872.00 | \$11,048.53 |
| 309 SCHINDLER DR | | 250169500 | \$826.91 | \$3,540.05 | \$0.00 | \$2,200.00 ** | 160 | \$1,536.00 | \$8,102.96 |
| 310 SCHINDLER DR | | 250169800 | \$826.91 | \$3,540.05 | \$2,609.57 * | \$2,200.00 ** | 166 | \$1,593.60 | \$10,770.13 |
| 315 SCHINDLER DR | | 250169400 | \$826.91 | \$3,540.05 | \$0.00 | \$2,200.00 ** | 225 | \$2,160.00 | \$8,726.96 |
| 316 SCHINDLER DR | | 250169900 | \$826.91 | \$3,540.05 | \$2,609.57 * | \$2,200.00 ** | 162 | \$1,555.20 | \$10,731.73 |
| 321 SCHINDLER DR | | 250169300 | \$826.91 | \$3,540.05 | \$0.00 | \$2,200.00 ** | 161 | \$1,545.60 | \$8,112.56 |
| 322 SCHINDLER DR | 5724 San Dell Way, Racine, WI 53402 | 250170000 | \$826.91 | \$3,540.05 | \$2,609.57 * | \$2,200.00 ** | 164 | \$1,574.40 | \$10,750.93 |
| 327 SCHINDLER DR | | 250169200 | \$826.91 | \$3,540.05 | \$0.00 | \$2,200.00 ** | 171 | \$1,641.60 | \$8,208.56 |
| 328 SCHINDLER DR | | 250170100 | \$826.91 | \$3,540.05 | \$2,609.57 * | \$2,200.00 ** | 155 | \$1,488.00 | \$10,664.53 |
| 333 SCHINDLER DR | | 250169100 | \$826.91 | \$3,540.05 | \$0.00 | \$2,200.00 ** | 166 | \$1,593.60 | \$8,160.56 |
| 334 SCHINDLER DR | | 250170200 | \$826.91 | \$3,540.05 | \$2,609.57 * | \$2,200.00 ** | 126 | \$1,209.60 | \$10,386.13 |
| 339 SCHINDLER DR | | 250169000 | \$826.91 | \$3,540.05 | \$0.00 | \$2,200.00 ** | 212 | \$2,035.20 | \$8,602.16 |
| 340 SCHINDLER DR | | 250170300 | \$826.91 | \$3,540.05 | \$2,609.57 * | \$2,200.00 ** | 110 | \$1,056.00 | \$10,232.53 |
| 345 SCHINDLER DR | | 250168900 | \$826.91 | \$3,540.05 | \$0.00 | \$2,200.00 ** | 165 | \$1,584.00 | \$8,150.96 |
| 346 SCHINDLER DR | | 250170400 | \$826.91 | \$3,540.05 | \$2,609.57 * | \$2,200.00 ** | 219 | \$2,102.40 | \$11,278.93 |
| 351 SCHINDLER DR | | 250168800 | \$826.91 | \$3,540.05 | \$0.00 | \$2,200.00 ** | 176 | \$1,689.60 | \$8,256.56 |
| 352 SCHINDLER DR | | 250170500 | \$826.91 | \$3,540.05 | \$2,609.57 * | \$2,200.00 ** | 172 | \$1,651.20 | \$10,827.73 |
| 356 SCHINDLER DR | | 250170600 | \$826.91 | \$3,540.05 | \$0.00 | \$2,200.00 ** | 122 | \$1,171.20 | \$7,738.16 |
| 357 SCHINDLER DR | | 250168700 | \$826.91 | \$3,540.05 | \$0.00 | \$2,200.00 ** | 187 | \$1,795.20 | \$8,362.16 |
| 364 SCHINDLER DR | | 250170700 | \$826.91 | \$3,540.05 | \$0.00 | \$2,200.00 ** | 168 | \$1,612.80 | \$8,179.76 |
| 365 SCHINDLER DR | | 250168600 | \$826.91 | \$3,540.05 | \$0.00 | \$2,200.00 ** | 164 | \$1,574.40 | \$8,141.36 |
| 370 SCHINDLER DR | | 250170800 | \$826.91 | \$3,540.05 | \$0.00 | \$2,200.00 ** | 179 | \$1,718.40 | \$8,285.36 |
| 373 SCHINDLER DR | | 250168500 | \$826.91 | \$3,540.05 | \$0.00 | \$2,200.00 ** | 192 | \$1,843.20 | \$8,410.16 |
| 376 SCHINDLER DR | | 250170900 | \$826.91 | \$3,540.05 | \$0.00 | \$2,200.00 ** | 222 | \$2,131.20 | \$8,698.16 |
| 381 SCHINDLER DR | | 250168400 | \$826.91 | \$3,540.05 | \$0.00 | \$2,200.00 ** | 164 | \$1,574.40 | \$8,141.36 |
| 382 SCHINDLER DR | | 250171000 | \$826.91 | \$3,540.05 | \$0.00 | \$2,200.00 ** | 193 | \$1,852.80 | \$8,419.76 |
| 388 SCHINDLER DR | | 250171100 | \$826.91 | \$3,540.05 | \$0.00 | \$2,200.00 ** | 0 | \$0.00 | \$6,566.96 |
| 1200 W KIMBERLY AVE | | 250153601 | \$826.91 | \$3,540.05 | \$0.00 | \$2,200.00 ** | 864 | \$8,294.40 | \$14,861.36 |
| 1213 SUNSET DR | | 250168200 | \$826.91 | \$0.00 | \$0.00 | \$2,200.00 ** | 0 | \$0.00 | \$3,026.91 |
| 1351 FULCER AVE | | 250154600 | \$0.00 | \$0.00 | \$0.00 | \$2,200.00 ** | 142 | \$1,363.20 | \$3,563.20 |
| 303 N ROGER ST | | 250154700 | \$0.00 | \$0.00 | \$0.00 | \$2,200.00 ** | 177 | \$1,699.20 | \$3,899.20 |

\$24,807.30 \$102,661.45 \$23,486.13 \$70,400.00 5,861 \$56,265.60 \$277,620.48

* Homes that are assumed to be properly connected to a Village approved private underground storm main will have their assessment deferred per Village Policy.

**Homes that are not connected to a Village provided storm lateral shall be required to install a private storm lateral to the sump pump discharge point at the home as part of this project.

SCHEDULE OF ASSESSMENTS

PINE STREET / WALNUT STREET ALLEY

VILLAGE OF KIMBERLY | OUTAGAMIE COUNTY, WISCONSIN



Concrete Apron Assessment Rate (S.F.) = \$12.40
 Asphalt Apron Assessment Rate (S.F.) = \$2.91

Estimated Lateral in R/W Assessment = \$826.91
 Estimated Average Cost of a Private Sanitary Lateral = \$3,785.16
 Estimated Private Storm Lateral = \$2,200.00

| Property Address | Mailing Address | Parcel No. | Estimated Sanitary Lateral In R/W Assessment | Estimated Private Sanitary Lateral Cost | Estimated Private Storm Lateral Cost | Estimated Concrete Apron Size (S.F.) | Estimated Concrete Apron Cost | Estimated Asphalt Apron Size (S.F.) | Estimated Asphalt Apron Cost | Estimated Total Assessment |
|--------------------------------------|--|------------|--|---|--------------------------------------|--------------------------------------|-------------------------------|-------------------------------------|------------------------------|----------------------------|
| 516 E FIRST ST | | 250039500 | \$826.91 | \$3,785.16 | \$2,200.00 ** | 0 | \$0.00 | 137 | \$398.67 | \$7,210.74 |
| 138 S PINE ST | | 250039600 | \$826.91 | \$3,785.16 | \$2,200.00 ** | 0 | \$0.00 | 0 | \$0.00 | \$6,812.07 |
| 132 S PINE ST | | 250039700 | \$826.91 | \$3,785.16 | \$2,200.00 ** | 0 | \$0.00 | 286 | \$832.26 | \$7,644.33 |
| 126 S PINE ST | | 250039800 | \$826.91 | \$3,785.16 | \$2,200.00 ** | 164 | \$2,033.60 | 124 | \$360.84 | \$9,206.51 |
| 118/120 S PINE ST | 711 CIRCLE HILL LA, SOBIESKI, WI 54171 | 250039900 | \$826.91 | \$3,785.16 | \$2,200.00 ** | 0 | \$0.00 | 296 | \$861.36 | \$7,673.43 |
| 114 S PINE ST | | 250040000 | \$826.91 | \$3,785.16 | \$2,200.00 ** | 0 | \$0.00 | 0 | \$0.00 | \$6,812.07 |
| 521 E KIMBERLY AV | 521 KIMBERLY AV E | 250040100 | \$826.91 | \$3,785.16 *** | \$2,200.00 ** | 0 | \$0.00 | 0 | \$0.00 | \$6,812.07 |
| 515 E KIMBERLY AV | | 250040200 | \$826.91 | \$3,785.16 | \$2,200.00 ** | 0 | \$0.00 | 0 | \$0.00 | \$6,812.07 |
| 509 E KIMBERLY AV | | 250040300 | \$826.91 | \$3,785.16 | \$2,200.00 ** | 160 | \$1,984.00 | 205 | \$596.55 | \$9,392.62 |
| 503 E KIMBERLY AVE / 109 S WALNUT ST | W4814 COUNTY RD S, BLACK CREEK, WI 54106 | 250040400 | \$826.91 | \$3,785.16 *** | \$2,200.00 ** | 0 | \$0.00 | 0 | \$0.00 | \$6,812.07 |
| 115 S WALNUT ST | | 250040500 | \$826.91 | \$3,785.16 | \$2,200.00 ** | 0 | \$0.00 | 0 | \$0.00 | \$6,812.07 |
| 121 S WALNUT ST | | 250040600 | \$826.91 | \$3,785.16 | \$2,200.00 ** | 0 | \$0.00 | 77 | \$224.07 | \$7,036.14 |
| 127 S WALNUT ST | | 250040700 | \$826.91 | \$0.00 | \$2,200.00 ** | 0 | \$0.00 | 150 | \$436.50 | \$3,463.41 |
| 127 S WALNUT ST | | 250040800 | \$826.91 | \$3,785.16 | \$2,200.00 ** | 0 | \$0.00 | 0 | \$0.00 | \$6,812.07 |
| 139 S WALNUT ST | | 250040900 | \$826.91 | \$3,785.16 | \$2,200.00 ** | 0 | \$0.00 | 0 | \$0.00 | \$6,812.07 |
| 510 E FIRST ST | | 250041000 | \$826.91 | \$3,785.16 | \$2,200.00 ** | 94 | \$1,165.60 | 0 | \$0.00 | \$7,977.67 |
| 518 E SECOND ST | | 250041200 | \$0.00 | \$0.00 | \$2,200.00 ** | 0 | \$0.00 | 0 | \$0.00 | \$2,200.00 |
| 244 S PINE ST | | 250041300 | \$0.00 | \$0.00 | \$2,200.00 ** | 188 | \$2,331.20 | 0 | \$0.00 | \$4,531.20 |
| 238 S PINE ST | | 250041400 | \$826.91 | \$3,785.16 | \$2,200.00 ** | 0 | \$0.00 | 0 | \$0.00 | \$6,812.07 |
| 232 S PINE ST | | 250041500 | \$826.91 | \$3,785.16 | \$2,200.00 ** | 0 | \$0.00 | 0 | \$0.00 | \$6,812.07 |
| 208 S PINE ST | 208 S PINE ST | 250041600 | \$826.91 | \$3,785.16 | \$2,200.00 ** | 0 | \$0.00 | 364 | \$1,059.24 | \$7,871.31 |
| 208 S PINE ST | 208 S PINE ST | 250041700 | \$826.91 | \$3,785.16 | \$2,200.00 ** | 0 | \$0.00 | 770 | \$2,240.70 | \$9,052.77 |
| 208 S PINE ST | 208 S PINE ST | 250041800 | \$826.91 | \$3,785.16 | \$2,200.00 ** | 54 | \$669.60 | 135 | \$392.85 | \$7,874.52 |
| 209 S WALNUT ST | | 250041900 | \$0.00 | \$0.00 | \$2,200.00 ** | 0 | \$0.00 | 0 | \$0.00 | \$2,200.00 |
| 203 S WALNUT ST | | 250042000 | \$826.91 | \$3,785.16 | \$2,200.00 ** | 0 | \$0.00 | 200 | \$582.00 | \$7,394.07 |
| 215 S WALNUT ST | 505 APPLEWOOD DR, KIMBERLY, WI 54136 | 250042100 | \$826.91 | \$3,785.16 | \$2,200.00 ** | 0 | \$0.00 | 0 | \$0.00 | \$6,812.07 |
| 221 S WALNUT ST | | 250042200 | \$826.91 | \$3,785.16 | \$2,200.00 ** | 116 | \$1,438.40 | 0 | \$0.00 | \$8,250.47 |
| 227 S WALNUT ST | | 250042300 | \$826.91 | \$3,785.16 | \$2,200.00 ** | 0 | \$0.00 | 157 | \$456.87 | \$7,268.94 |
| 233 S WALNUT ST | | 250042400 | \$826.91 | \$3,785.16 | \$2,200.00 ** | 0 | \$0.00 | 714 * | \$2,077.74 | \$8,889.81 |
| 239 S WALNUT ST | | 250042500 | \$826.91 | \$3,785.16 | \$2,200.00 ** | 0 | \$0.00 | 316 | \$919.56 | \$7,731.63 |
| 245 S WALNUT ST | | 250042600 | \$826.91 | \$3,785.16 | \$2,200.00 ** | 0 | \$0.00 | 173 | \$503.43 | \$7,315.50 |
| 251 S WALNUT ST | | 250042700 | \$0.00 | \$0.00 | \$2,200.00 ** | 117 | \$1,450.80 | 113 | \$328.83 | \$3,979.63 |
| 503 E THIRD ST | W5875 SWEET WILLIAM DR, APPLETON, WI 54915 | 250044800 | \$826.91 | \$3,785.16 | \$2,200.00 ** | 0 | \$0.00 | 0 | \$0.00 | \$6,812.07 |
| 509 E THIRD ST | | 250044900 | \$826.91 | \$3,785.16 | \$2,200.00 ** | 0 | \$0.00 | 0 | \$0.00 | \$6,812.07 |
| 521 E THIRD ST | | 250045000 | \$826.91 | \$3,785.16 | \$2,200.00 ** | 0 | \$0.00 | 0 | \$0.00 | \$6,812.07 |
| TOTAL | | | \$25,634.21 | \$113,554.80 | \$77,000.00 | 893 | \$11,073.20 | 4,217 | \$12,271.47 | \$239,533.68 |

*Includes driveway paving to garage to conform to Village ordinances.

**Homes that are not connected to a Village provided storm lateral shall be required to install a private storm lateral to the sump pump discharge point at the home as part of this project.

***Private lateral cost anticipated to be higher than typical due to length and complexity.

VILLAGE OF KIMBERLY
WAIVER AND CONSENT TO SPECIAL ASSESSMENTS AND/OR CHARGES
AND RIGHT TO ACCESS

The undersigned do hereby acknowledge that they are owners of property located in Kimberly, Wisconsin, and are, by and through this instrument, voluntarily waiving any and all statutory assessment procedures, and further irrevocably consenting to the imposition of special assessments, charges, and/or taxes for public improvements or services specially benefiting the property located at _____, Kimberly, Wisconsin being Tax Parcel No. _____.

The project, services, or improvements, and cost to be imposed if known, for which this Waiver and Consent is granted are described as follows:

- Private Sanitary Lateral Connection: Cost is unknown. Actual cost based on footage, products, and costs incurred. (Additional information provided on Estimated Assessment page.)**

- Private Storm Lateral Connection: Cost is unknown. Actual cost based on footage, products, and costs incurred. (Additional information provided on Estimated Assessment page.)**

This Waiver is a specific waiver of all rights afforded the undersigned by Chapter 66 Wisconsin Statutes, with respect to notice of public hearings, review of engineering reports, the review of plans and specifications, the timing of the construction, or performance of services, and all rights of objection or appeal. The undersigned acknowledge that the Village of Kimberly is relying on this Waiver and Consent to incur expenditures which will be assessed against the property above and will become a lien on the real estate and shown on the tax bill for the property until the assessment is paid in full, all pursuant to police powers granted to the Village of Kimberly by state law. Billing, payment procedures, and interest charges for deferred payments will be in accordance with those policies in effect at the Village at the time the assessments, charges, or taxes are imposed.

Right to Access. The undersigned further grant to the Village of Kimberly, its officers, employees, agents, contractors, and subcontractors, a non-exclusive license and right to access the property identified above as reasonably necessary to inspect, access, stage equipment or materials, and to construct, install, maintain, repair or complete the public improvements or services described herein. This right of access shall include use of construction equipment, vehicles and personnel as needed to perform the work.

The Village shall use reasonable care during all activities on the property and shall restore disturbed areas to a condition of turf similar to their pre-entry state, except where such disturbance is inherent to the installation or completion of the improvements. The Village will provide reasonable advance notice of entry when practicable, except where immediate entry is required for safety, continuity of work, or other operational necessity.

This instrument does hereby constitute a voluntary waiver of such rights of the undersigned and authorizes the Village of Kimberly to proceed with the project pertaining to the property owned by the undersigned without the need to adhere to the statutory requirements set forth in Chapter 66 Wisconsin Statutes, specifically including but not limited to § 66.0703, § 66.0627, and § 66.0907 Wisconsin Statutes.

Dated and effective this _____ day of _____, 20_____.

_____/_____
Name(s) of Property Owner(s) – Please print

_____/_____
Signature(s): Property Owner(s) (only one required, optional for both)

Witness Signature: _____

Property Owner's Phone number: _____

Property Owner's Email address: _____